

Worth & Associates

BESPOKE ALUMINIUM CRAFTSMANSHIP, LOCALLY
MANUFACTURED WITH EXCLUSIVE GLOBAL PARTNERSHIPS

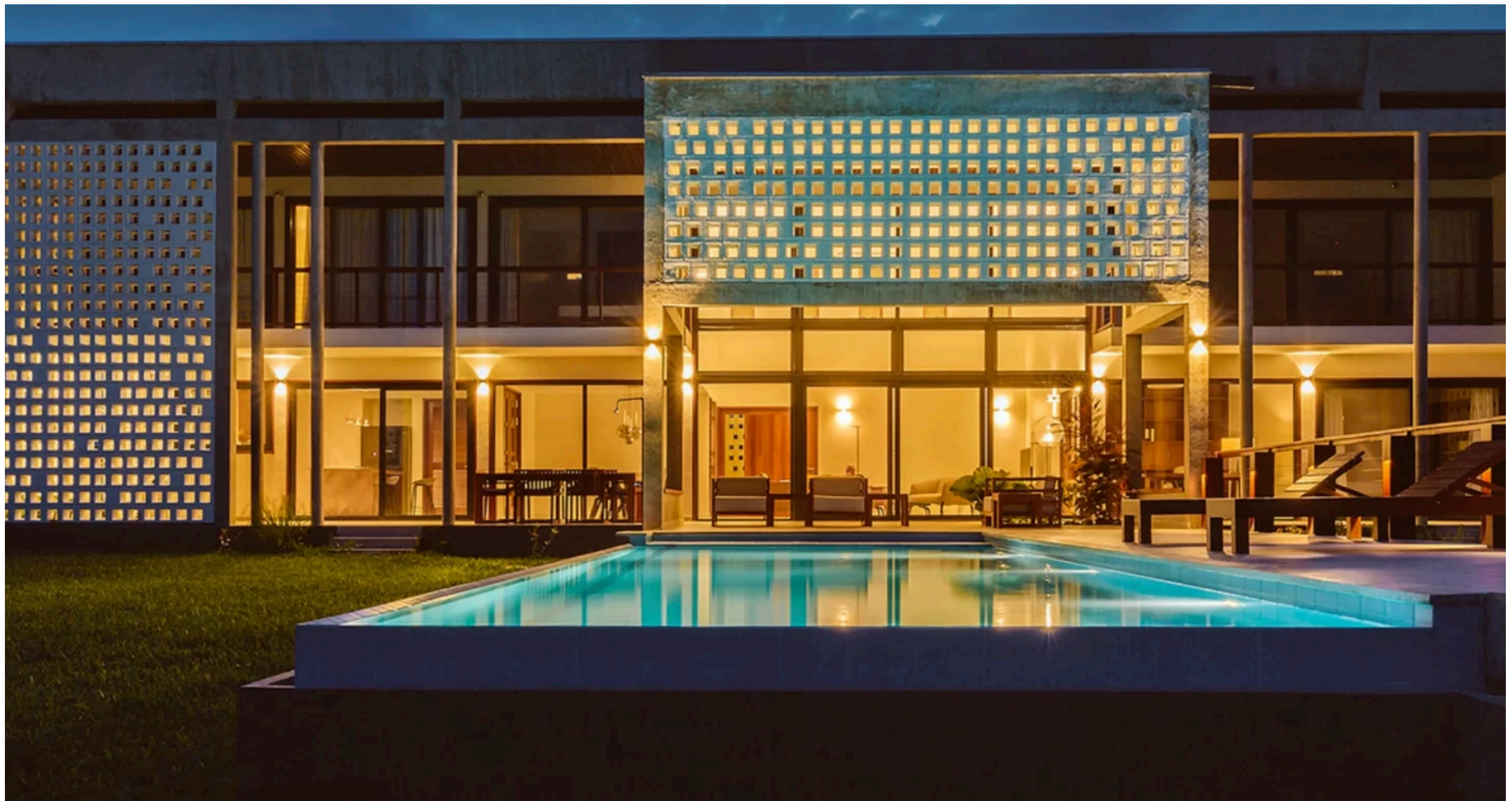

*Mbweni House
Dar Es-Salam, Tanzania*

IMAGINE BEYOND POSSIBILITY

WE ARE PART OF TOMORROW



All in all, the traditional Coastal Swahili House and the vernacular Colonial Planters' house might have been the inspiration for this project and resulted in a context and climate responsive design,

WORTH Associates & Aluminium in exclusive partnership with ALUMINCO RSA provides a bespoke platform encompassing the worlds of design, procurement and manufacturing to the highest international standards. Locally!

For forty two years Aluminco has been designing and developing innovative solutions for architectural aluminium systems, standing for Greek quality, in more than 60 countries.

Our history already counts 42 years of continuous evolution. In our modern production facilities, we design and develop every day, advanced architectural aluminium systems for doors and windows, railings, pergolas, fences, photovoltaic panel support systems, etc., products that carry strong certifications from internationally recognised bodies.

Today, the ALUMINCO Group is among the largest Greek aluminium industries and among the most recognized worldwide, with 3 factories in Oinofita, Viotia and Kalochori, Thessaloniki, with a total area of 150,000 sq.m. with the most modern production lines, 4 subsidiaries, privately owned branches and more than 2,500 points of sale, while it has a total of more than 400 employees.

The Future Of Construction

SUSTAINABLE ARCHITECTURE & CONSTRUCTION

Global Trends

Global trends, such as, increasing urbanisation, the merging of professional and private life and growing environmental awareness are defining the future of the construction industry and, furthermore, of the aluminium market products.

Aluminco In Numbers

Our history counts 39 years of continuous evolution. In our state-of-the-art, 60,000 sq.m. facility, we design and produce innovative aluminium architectural systems for new constructions and renovations, in order to meet specific needs for different climate zones. With an export network serving the most important markets in Europe, Africa, Asia and the Americas.

“ALUMINCO’s goal is sustainable architecture that considers socio-cultural aspects to the same extent as economic and ecological qualities, with the aim of bringing people, space and environment in harmony.”

Empowering Possibilities, Elevating Spaces

Worth Associates & Aluminium envisions a world where architectural boundaries are limitless, and spaces are elevated to new heights of beauty, functionality, and sustainability. **By harnessing cutting-edge technology, creative ingenuity, and a deep understanding of design, we aspire to be the pioneers in setting new standards for aluminum doors and windows.** Our vision encompasses creating spaces that inspire, enrich, and seamlessly blend with the surrounding environment. **Through unwavering dedication to innovation, craftsmanship, and a sustainable future, we envision Worth Aluminium as a beacon of excellence** that shapes architectural marvels and transforms the way people experience the world around them.

EXCLUSIVE MAXIMUM ENERGY SAVING PRODUCT PREVIEW

Tilt & Turn Thermal Insulating System Maximum energy saving

This line's wide range of profiles offer numerous innovative solutions, from flat to curved sections, as well as the ability to apply complex typologies such as "aller-retour" doors, rotating windows and opening frames with hidden sash in order to achieve a high-level aesthetics. The available profiles collaborate perfectly with high-quality components and mechanisms which underline the system's **multifaceted and ergonomic nature.**

The system's non-negotiable priority for **maximum energy savings and high safety** is ensured due to the possibility of perimeter locking and the use of 24 mm reinforced polyamides offering a **Thermal insulation Index $U_f=2.2-2.6 \text{ W/m}^2\text{K}$ and a Sound Reduction Index R_w of 43 dB.**

Reference point is the use of the least possible visible aluminum, the **W450 hidden sash edition** which offers a simple



W450 is a complete high-performance thermal insulation system meeting the needs for contemporary energy efficiency, sound reduction, aesthetics and safety.

and elegant aesthetic effect along with the safety and functionality ensured by the perimeter mechanism. Its contemporary architectural design is reflected not only in its modern appearance but also in its minimum **72 mm face height** that maximizes the field of vision and at the same time allows the maximum possible

flow of natural light inside the building. The use of **31.8 mm glass reinforced polyamides** ensures a **high thermal insulation of U_f from $1.6 \text{ W/m}^2\text{K}$** , while specially designed **EPDM gaskets** and advanced perimeter mechanism ensure absolute water tightness and wind resistance.

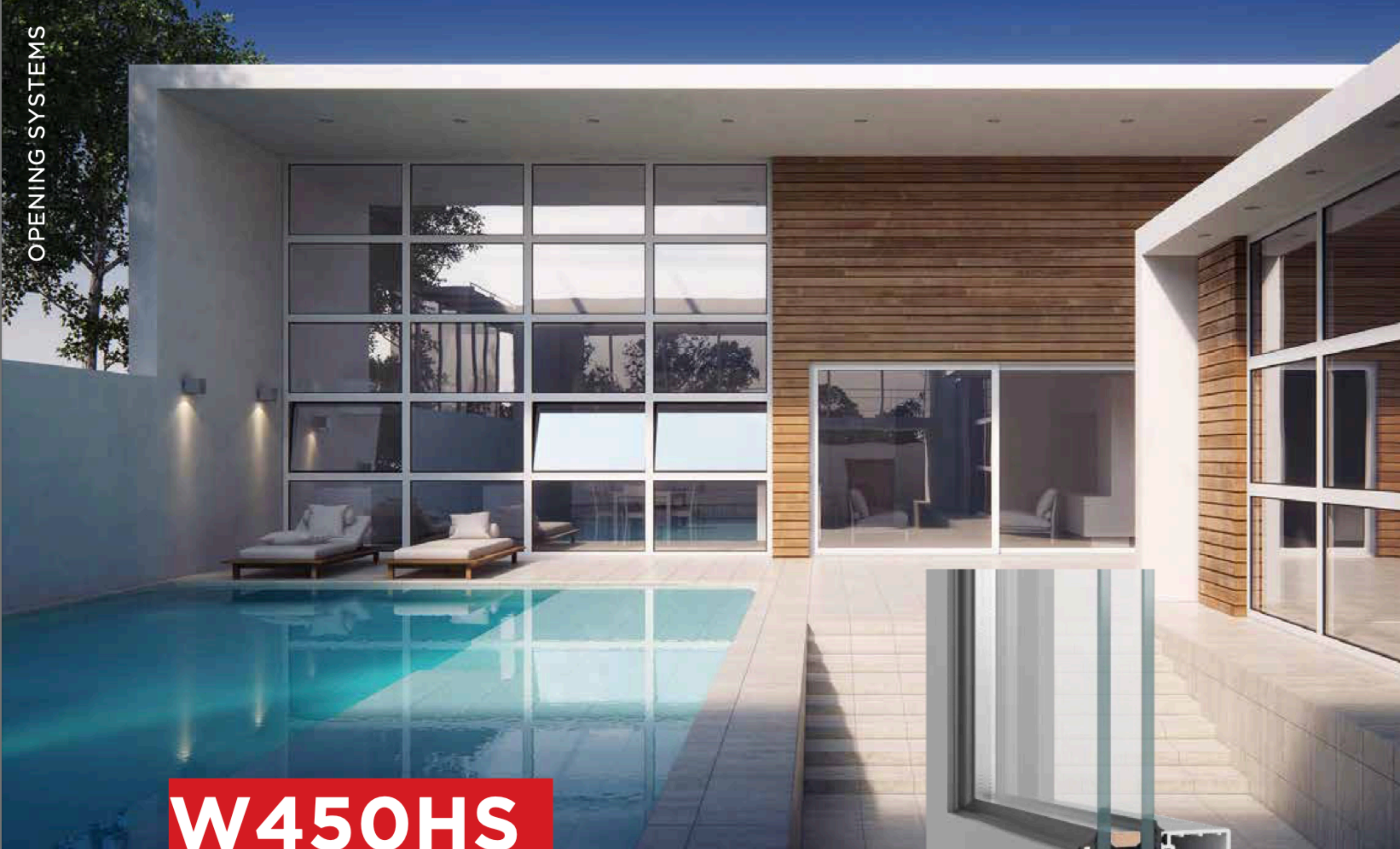

W450HS

Tilt & Turn Thermal Insulating System
An exceptional aesthetic result.



System Identity

The system W450 HS fully safeguards the sense of simplicity, pure and elegant aesthetic effect.

Reference point is the use of the least possible visible aluminum which gives the system a sense of grandeur.

The muscular appearance confirms the dynamic orientation of the series and the attention to detail is reflected, in addition to aesthetics, to the practicality and usability of the system.

Features & Benefits

- Hidden sash with frame height 72 mm
- Use of glass reinforced polyamides of 30 mm
- High thermal insulation
- Frameless hinged robust constructions of special design

Configurations

Casement-awning windows

1Leaf - 2Leaf & 1Leaf with fixed



FLAT

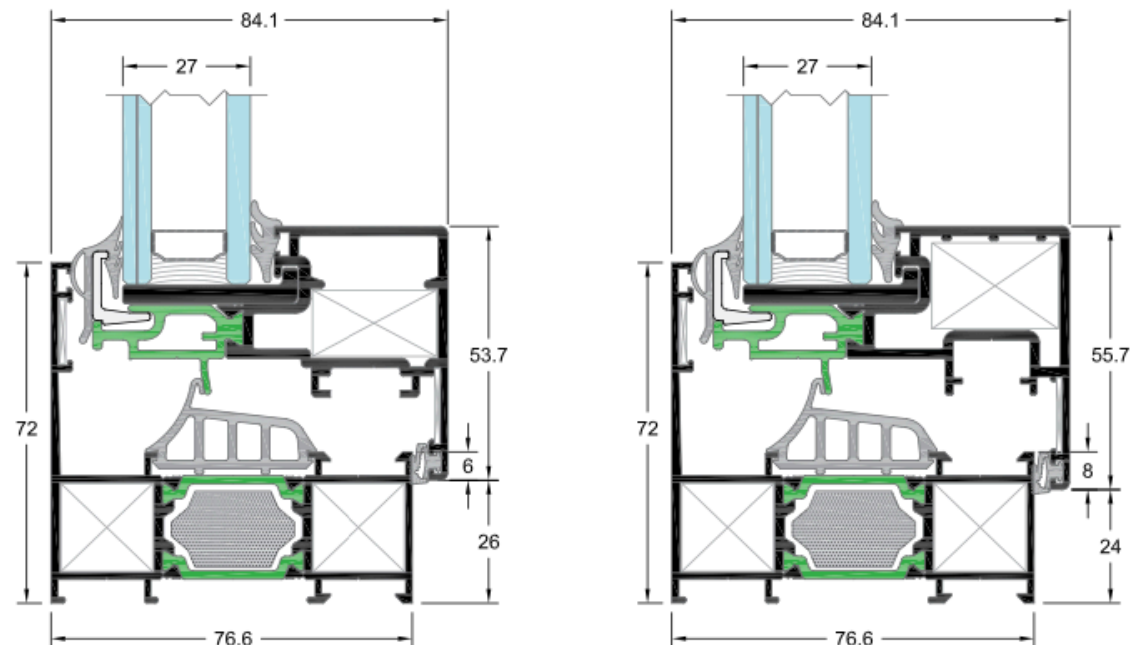

HARDWARE

CAMERA	CE	ALU 16
--------	----	--------

INSULATION

POLYAMIDES mm	30	30
FOAM	■	■

SYSTEM PROFILE DIMENSIONS

MIN. FRAME DEPTH mm	76.6	76.6
MIN. FACE HEIGHT mm	72 OUT / 79.7 IN	72 OUT / 79.7 IN
GLASS THICKNESS mm	27	27

CONSTRUCTION DIMENSIONS

SASH WIDTH mm	365-1600	360-1490
SASH HEIGHT mm	360-2400	450-2360
MAX. SASH DIMENSIONS mm (WxH)	1600x2100 / 1300x2400	1490x2100 / 1300x2360
MAX. SASH WEIGHT Kg	130, 150*, 200**	130, 150*, 200**

CERTIFICATES/PERFORMANCES

AIR PERMEABILITY EN 12207	N/A	Class 4
WATER TIGHTNESS EN 12208	N/A	Class 7A
RESISTANCE TO WIND LOAD EN 12210	N/A	Class B4
THERMAL INSULATION U_f EN ISO 10077-2	1.6-2.8 W/m ² K	1.6-2.8 W/m ² K

*Reinforced Tilt and Turn | **Hinged with heavy duty hinges



Rate of Insulation

$U_w=1.76 \text{ W/m}^2\text{K}$

Thermal conductivity coefficient has been calculated for the construction: 1600x2200 with $U_g=1.1 \text{ W/m}^2\text{K}$
Glass type: 3+3 /16(ARGON)/5

EXCELLENT QUALITY & DURABILITY

More Than A Property

Every building, our home, should be much more than a property. It should offer a sense of well-being and the freedom to embrace our individuality. It should be a living organism. Filled with natural light and connect the inside with the outside environment. Provide thermal and acoustic comfort. Offer a healthy indoor climate and give us security. To be a sustainable solution for the future. To be ALUMINCO.

Aluminium systems of ALUMINCO can combine many different designs, offer a high level of safety, high thermal and sound insulation and excellent durability. They have been studied in detail and are the best examples in their category, clearly demonstrating the position the company wants to establish in the new world order and the energy trends of the market.

Non-Negotiable Quality

ALUMINCO quality is a non-negotiable value for the company's people. By constantly strengthening and upgrading



Our home, should be much more than a property. It should offer a sense of well-being and the freedom to embrace our individuality

our production capacity, investing in machinery and new technologies. With certifications from recognised institutes and international organisations. With products that stand the test of time and act as a magnet for most users. With projects that capture even the most demanding eyes.

Aluminium systems offer doors and windows with high robustness and therefore increased safety and durability. Aluminium is a highly durable metal that can remain unchanged for many decades. It exhibits excellent resistance to corrosion and requires minimal maintenance

HIGH THERMAL & SOUND INSULATION

REAL PROTECTION

Moreover, as a material it is capable of multiple treatments, fully preserving its characteristics. Thus, the surface painting and anodising treatments that are usually applied to aluminium profiles shield the frame and protect it from corrosion.

HIGH THERMAL & SOUND INSULATION

Thermal and sound insulation are top criteria in the selection of aluminium frames because they upgrade buildings, improve the quality of life of the users and contribute to the protection of the environment.

- Thermal transmittance defines how easily heat (measured in watts) passes through a material of a certain thickness and area of one square meter in one hour. It should be remembered that the flow of heat is always in the direction from the hottest to the coolest.
- The annoyance caused by external noise degrades the quality of life and has a negative impact on health, living and communication. It is significant that the World Health Organization considers noise pollution to be the second most important environmental health risk. Sound insulation is an important factor in the choice of frames.

MINIMAL DESIGN & AESTHETIC FUNCTIONALITY

The phrase of the German American representative of the modernist architectural movement Miss Van de Rohe, "Less Is More", is nowadays a key design principle and is applied to achieve spaces that have a way to impress, activating the senses without much effort.

The main highlight of the house and the element that distinguishes its design are the glazed surfaces. The overall design philosophy of the Fielding House is derived from the traditional architecture of the mid-20th century, with clean lines and simple elements, all betting on functionality and ultimate comfort.

The clean, simple lines, the maximisation of the field of vision and thus natural lighting, the seamless transition between large windows and large sliding doors that make the interior environment "one" with the outside and enchanting the top aesthetics that focus on functionality and comfort, are reference points and contribute decisively to improving the quality of life of the users.

MAXIMUM SECURITY

PROTECTION FROM INTRUSION

The protection of a building from the intrusion of unwanted visitors is implemented by considering all the openings to the internal environment and applying to each of them the appropriate anti-burglary protection frame, depending on the risk of intrusion and the resistance it must demonstrate.

Entrance doors, windows, balcony doors represent the “weak points” of protection against burglars, even when closed and locked, due to their lower strength compared to the masonry of the building.

The aluminium frames are certified by internationally recognised organisations and meet the highest safety standards. They are evaluated with a six-tier system (RC1 to RC6 in increasing order of burglary resistance), describing the level of resistance to static and dynamic pressure, with different tools as well as manual burglary attempts.

MINIMAL DESIGN & AESTHETIC FUNCTIONALITY

The phrase of the German American representative of the modernist architectural movement Miss Van de Rohe, “Less Is More”, is nowadays a key design principle and is applied to achieve spaces that have a way to impress, activating the senses without much effort.

The main highlight of the house and the element that distinguishes its design are the glazed surfaces. The overall design philosophy of the Fielding House is derived from the traditional architecture of the

mid-20th century, with clean lines and simple elements, all betting on functionality and ultimate comfort.

The clean, simple lines, the maximisation of the field of vision and thus natural lighting, the seamless transition between large windows and large sliding doors that make the interior environment “one” with the outside and enchanting the top aesthetics that focus on functionality and comfort, are reference points and contribute decisively to improving the quality of life of the users.

IMPROVED AIR-WATER-WIND PERFORMANCE

European standards provide for the classification of aluminium systems into categories according to their performance in terms of air permeability, watertightness, and wind pressure resistance.

- The thermal insulation properties of a frame are determined both by its ability to prevent the passage of hot or cold air through its joints and by its ability to prevent the spread of heat through the materials of which it is made.
- Waterproofing or liquid proofing is the process by which a structure is made impermeable to water by the application of specific waterproofing materials.
- Air sealing in aluminium systems is an important factor that affects thermal as well as sound insulation. In both cases, the glazing is a decisive factor. Another aspect related to the quality of the construction of the windows and affecting the climate of the house is wind resistance

SHOWCASING THE GREAT WIDE AT SIX SENSES LA SAGESSE RESORT

Discover THE GREAT WIDE: Elevating Luxury at Six Senses La Sagesse Resort

We're proud to showcase the role of our premier product, **THE GREAT WIDE: SL2700 Lift & Slide Thermal Insulating System**, in the breathtaking Six Senses La Sagesse Resort in Grenada.

About THE GREAT WIDE: SL2700

The SL2700 represents the new generation of ALUMINCO's high-end systems, designed specifically for luxury structures. This lift-and-slide system is characterized by:

- **Slim Lines & Greater Visibility:** The narrow interlocking face width permits a greater flow of natural light, enhancing the architectural aesthetics and providing an exceptionally uplifting atmosphere.
- **Thermal Insulation:** Excellent thermal insulation values ensure energy efficiency, maintaining a comfortable environment in any climate.
- **High-Quality Components:** High-quality components guarantee durability and longevity, making it a reliable choice for high-end projects.



PROJECT HIGHLIGHT: SIX SENSES LA SAGESSE RESORT

ABOUT THE GREAT WIDE/CONT.

- **Ground Level Threshold:** Offers high comfort and ease of access, blending seamlessly with the floor to create a smooth transition between indoor and outdoor spaces.
- **Wide Span Capability:** Exceeding conventional applications, SL2700 is perfect for large openings, providing architects with more opportunities to create expansive, open environment.

Project Highlight: Six Senses La Sagesse Resort

The luxury hotel group Six Senses, known for its sustainable and innovative developments, chose our SL2700 system for their Caribbean debut. The resort's design, influenced by the local Caribbean architecture, features 56 two-level pool suites and 15 villas, all constructed with natural, renewable, and reused materials.

Why SL2700?

The SL2700 was integral in achieving the resort's design goals, offering:

- **Maximal Transparency:** Ensuring unobstructed views of the turquoise sea and the lush Grenadian landscape.

- **Energy Efficiency:** Providing excellent thermal insulation, crucial for maintaining comfort in the tropical climate.
- **Seamless Integration:** The ground level threshold and slim lines created a smooth, continuous flow between the interior and exterior spaces, enhancing the guest experience.

The Outcome:

With SL2700, Six Senses La Sagesse achieves a perfect blend of luxury, sustainability, and innovative design. Our system's high performance and aesthetic appeal align perfectly with the resort's commitment to responsible practices and exceptional guest experiences.

Join the Conversation:

Learn more about how our advanced aluminum systems can transform your next architectural project. Contact us at: nikos@worth-int.com or visit our showroom to explore the possibilities.



SL2700

Lift & Slide Thermal Insulating System
High-end structures.



System Identity

The lift-and-slide system SL2700 represents the new generation of ALUMINCO's high-end systems.

Attractive and effective slim lines, excellent thermal insulation values and high-quality components create an exceptionally uplifting atmosphere.

The architectural aesthetics are depicted on the narrow interlocking face width which permits greater visibility and flow of light, while the ground level threshold offers high comfort and ease of access.

Exceeding conventional applications and fulfilling the need for wide spans, SL2700 offers more opportunities and options to the modern professional, therefore upgraded in one of the most efficient systems in its category.

Features & Benefits

- Exceptional energy efficiency
- Impressive thermal insulation, water tightness and resistance to wind pressure.
- Minimal style and straight lines in combination with the low-level and flat threshold of 25 mm offer particularly elegant structures and facilitate the access
- Interlocking face width of only 43 mm for maximum transparency and light penetration
- The concealed lift-sliding mechanism offers smooth sliding and phenomenal functionality
- Perimetrical sealing with EPDM gaskets
- Multi-point lock with lift-and-slide for high burglar resistance.
- Wide variety of typologies and solutions with a great flexibility in construction
- Ideal for hotel units offering unique hotel solutions.

Configurations

Lift - sliding

2Leaf sliding, 3Leaf sliding, 4Leaf double sliding, 6Leaf double sliding, 2Leaf sliding with insect screen, 2Leaf sliding with fixed, 2Leaf sliding with fixed and insect screen, 1Leaf sliding with fixed

Angular structure 90°

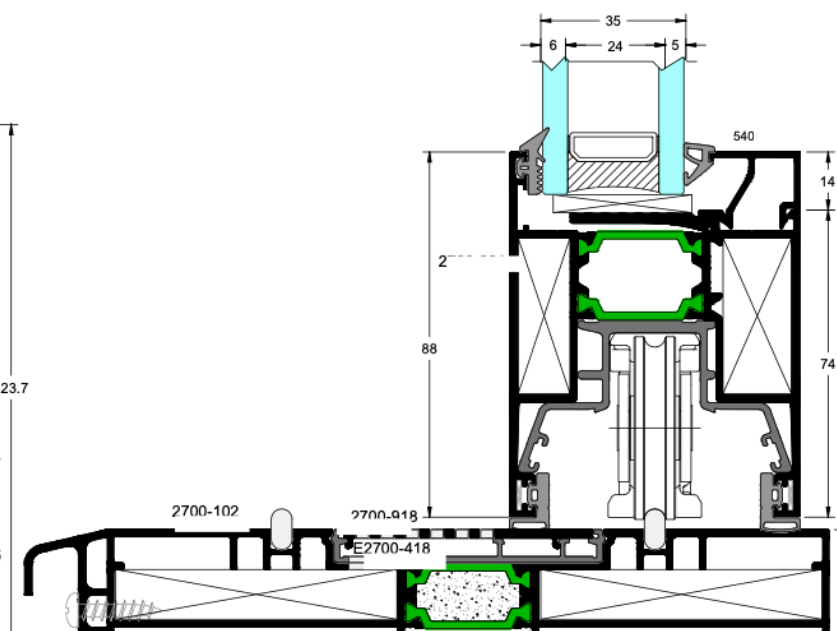
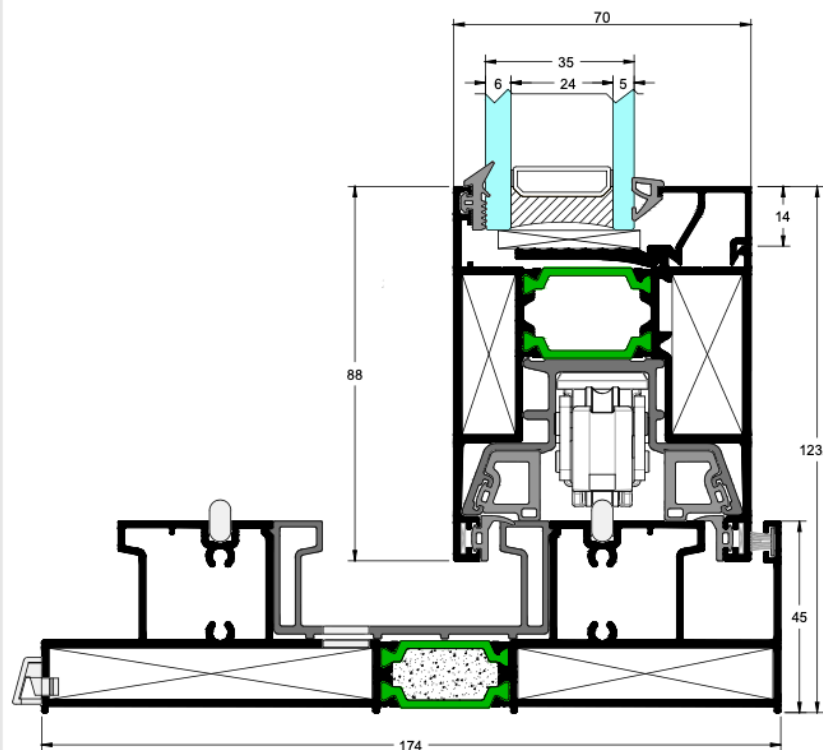

HARDWARE

SLIDING

LIFT & SLIDE

INSULATION

POLYAMIDES mm 30

SYSTEM PROFILE DIMENSIONS

FRAME HEIGHT mm	25
FRAME WIDTH mm	174
SASH HEIGHT mm	88
SASH WIDTH mm	70
INTERLOCKING PROFILE WIDTH mm	35/43
SASH WEIGHT Kg	up to 400
GLASS THICKNESS mm	22-52

CERTIFICATES/PERFORMANCES

AIR PERMEABILITY EN 12207	Class 4
WATER TIGHTNESS EN 12208	Class 9A
RESISTANCE TO WIND LOAD EN 12210	Class B4
SOUND REDUCTION R_w (C;Ctr) ISO 10140-2	42 (0;-3)cdB
THERMAL INSULATION U_f EN ISO 10077-2	1.7-8.1 W/m ² K



Rate of insulation:

$U_w=1.55$ W/m²K

Thermal conductivity coefficient has calculated for the construction:

4000x2400 with $U_g=1.0$ W/m²K

Glass type: 5/24 (ARGON) /6





WORTH
INTERNATIONAL

**Visit Our Showroom For An Exclusive Preview & Personalised Consultation:
Headquarters 84 Rigger Road, Spartan, Kempton Park, Gauteng, , Kempton Park,
Gauteng 1619, ZA /+27 65 349 9030/Email: nikos@worth-int.com/Visit our Website:
<https://www.worth-associates.com/>**